



LEGEND

EXISTING	PROPOSED
Combined Sewer	Combined Sewer
Sanitary Sewer	Sanitary Sewer
Storm Sewer	Storm Sewer
Storm Manhole	Storm Manhole
Storm Manhole Catch Basin	Storm Manhole Catch Basin
Inlet	Inlet
Water Main & Services Valve & Vault	Water Main & Services Valve & Vault
Pressure Connection	Pressure Connection
Valve & Box	Valve & Box
Fire Hydrant	Fire Hydrant
Structure to be Abandoned	Structure to be Abandoned
Power Pole	Power Pole
Access Easement	Access Easement
Contour	Contour
Drainage Arrow	Drainage Arrow
Neighb. Fram. & Lid No.	Neighb. Fram. & Lid No.
Structure Size "d"	Structure Size "d"
Type	Type
Structure No. - 1-A(48) R-177-B	Structure No. - 1-A(48) R-177-B
Form Elevation	Form Elevation
Invert Elevation	Invert Elevation

TOPOGRAPHIC SURVEY

ATTENTION: DAVID BYCROFT, P.L.S.
NORMAN J. TOBERMAN & ASSOCIATES, LLC
CONSULTING CIVIL ENGINEERS & SURVEYORS
115 S. WILKE ROAD SUITE 301
ARLINGTON HEIGHTS, IL 60005
P: (847) 439-8225
F: (847) 749-4104

ARCHITECT

OKW ARCHITECTS
600 W. JACKSON BLVD.
SUITE 250
CHICAGO, IL 60661
P: (312) 798-7773

NORMAN J. TOBERMAN & ASSOCIATES, LLC

CONSULTING CIVIL ENGINEERS
SURVEYORS
115 S. WILKE ROAD, SUITE 301
ARLINGTON HEIGHTS, IL 60005
P: (847) 439-8225
F: (847) 749-4104
mail@toberman.us
www.toberman.us

DESIGN FIRM NO: 184005910
EXPIRES: 04-30-23

No.	Date	Revision

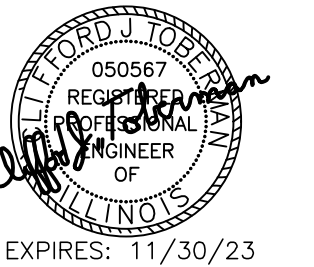

Proposed Building
Lot 2
Bella Vista Parkway
Warrenville, IL

NJT Project No:
22-7403

UTILITY PLAN

Sheet No.
C-4
Plot Date: 01-11-23

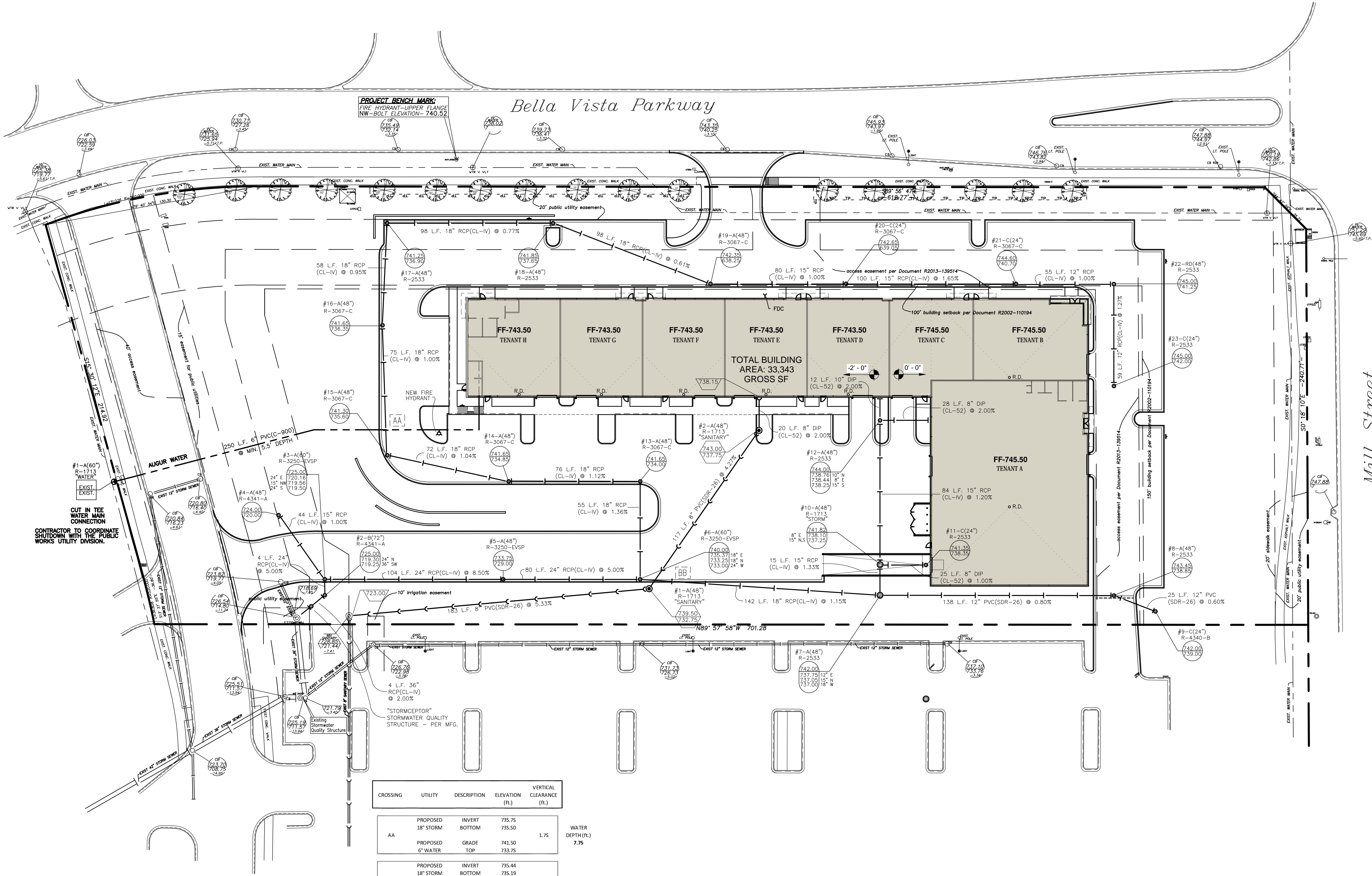

PROJECT BENCH MARK
FIRE HYDRANT - UPPER FLANGES
NW - BOLT ELEVATION = 740.52

Bella Vista Parkway

Mill Street

TOTAL BUILDING AREA: 33,343 GROSS SF

FF-743.50 TENANT H

FF-743.50 TENANT G

FF-743.50 TENANT F

FF-743.50 TENANT E

FF-743.50 TENANT D

FF-745.50 TENANT C

FF-745.50 TENANT B

FF-745.50 TENANT A

CUT IN TEE WATER MAIN CONNECTION
CONTRACTOR TO COORDINATE SHUTDOWN WITH THE PUBLIC WORKS UTILITY DIVISION.

CROSSING	UTILITY	DESCRIPTION	ELEVATION (ft.)	VERTICAL CLEARANCE (ft.)
AA	PROPOSED	18" STORM	735.75	1.75
	PROPOSED	6" WATER	733.75	
BB	PROPOSED	18" STORM	735.44	1.53
	PROPOSED	8" SANITARY	732.96	

WATER DEPTH (ft.) 7.75